

A Elevation at unit
 Scale: 3/4" = 1'
 Make 1 unit as drawn

Hinge Type:
 Stanley F191 4 1/2" x 4 1/2",
 US10B finish, 4 ea.

Wood Species:
 Door: Paint grade Sapele
 Frame: Paint grade Sapele

Items shown in **BLUE** are supplied
 by manufacturer, items shown in
RED are supplied by others and
 shown for location purposes only

Glazing Type:
 1/8" Cardinal 272 Low-E over 1/8"
 clear, tempered, black foam spacer,
 argon gas filled, 7/8" O.A.

Exterior Pair with Sidelights

Contractor
 Architect
 Job Name
 Exterior Doors

Started: 3/23
 Drawn By:EH
 Project #:

0000

SHEET
1

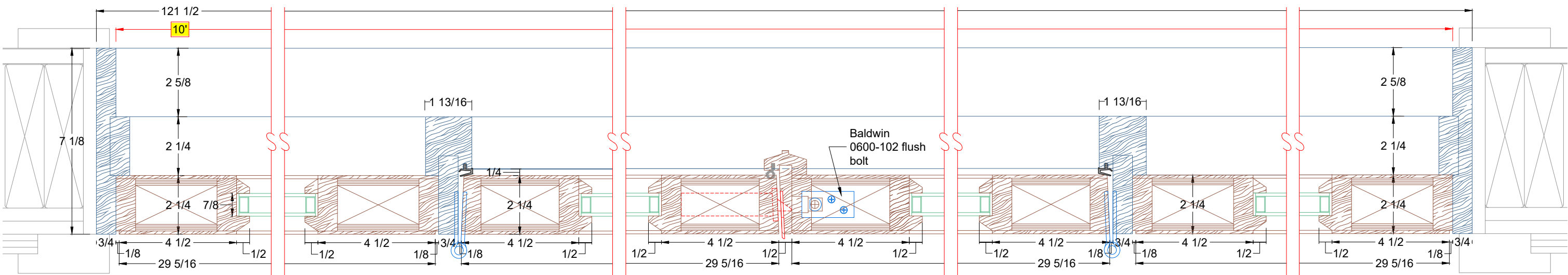

A Detail at plan view
Scale: 3" = 1'

Hinge Type:
Stanley F191 4 1/2" x 4 1/2",
US10B finish, 4 ea.

Wood Species:
Door: Paint grade Sapele
Frame: Paint grade Sapele

Items shown in **BLUE** are supplied
by manufacturer, items shown in
RED are supplied by others and
shown for location purposes only

Glazing Type:
1/8" Cardinal 272 Low-E over 1/8"
clear, tempered, black foam spacer,
argon gas filled, 7/8" O.A.

Contractor
Architect
Job Name
Exterior Doors

Started: 3/23
Drawn By:EH
Project #:

0000

SHEET
2

Exterior Pair with Sidelights

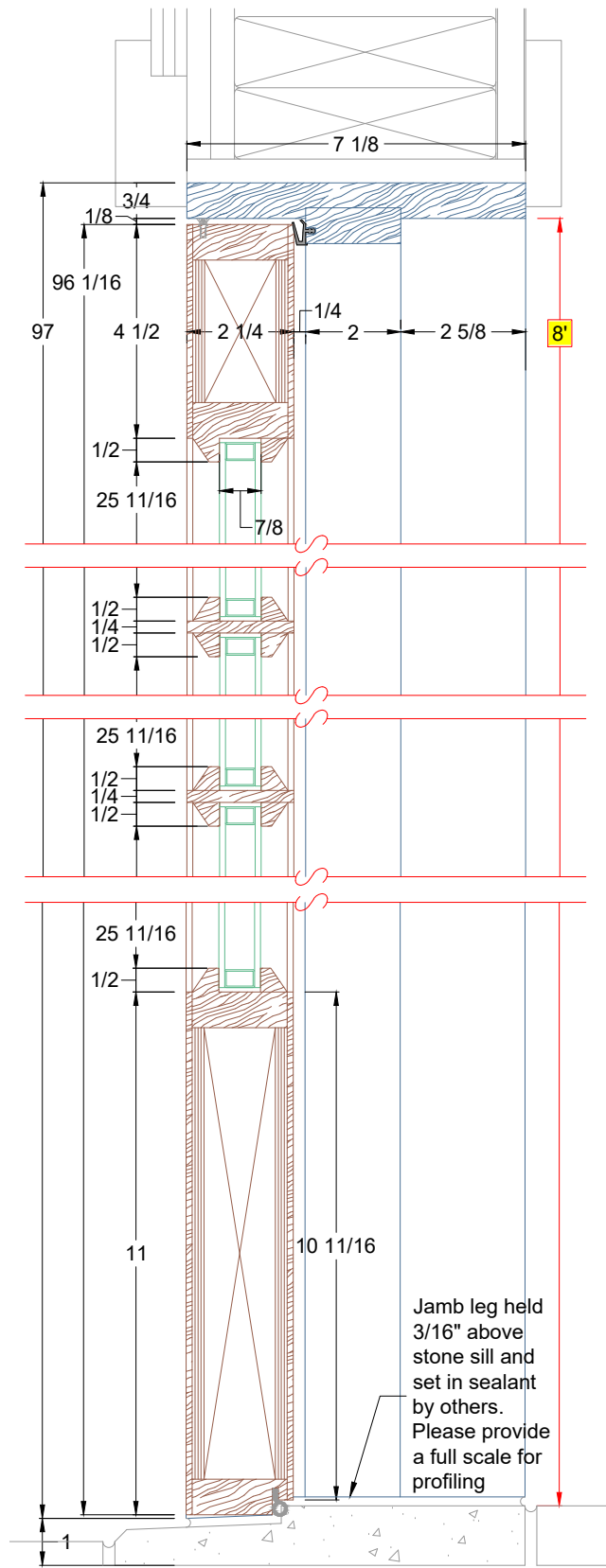

A Detail at head and sill
Scale: 3" = 1'

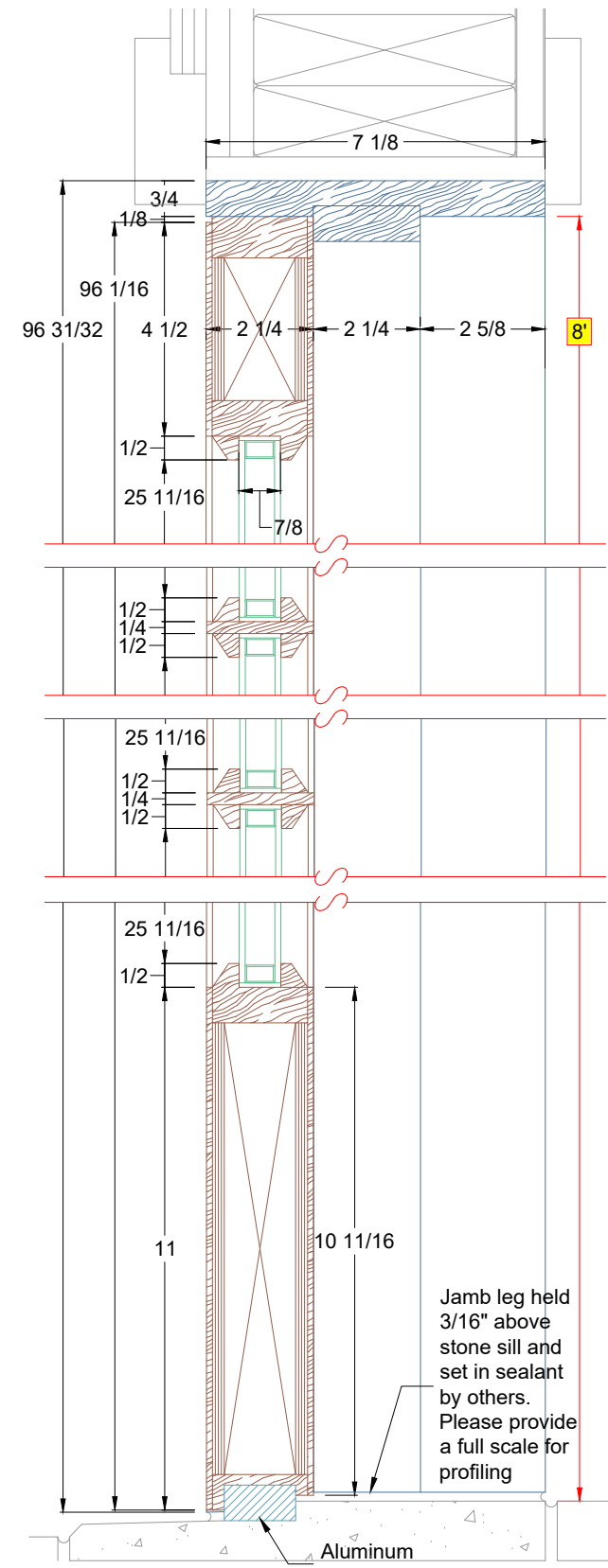

B Detail at head and sill
Scale: 3" = 1'

Hinge Type:
Stanley F191 4 1/2" x 4 1/2",
US10B finish, 4 ea.

Wood Species:
Door: Paint grade Sapele
Frame: Paint grade Sapele

Items shown in **BLUE** are supplied
by manufacturer, items shown in
RED are supplied by others and
shown for location purposes only

Glazing Type:
1/8" Cardinal 272 Low-E over 1/8"
clear, tempered, black foam spacer,
argon gas filled, 7/8" O.A.

Exterior Pair with Sidelights

Contractor
Architect
Job Name
Exterior Doors

Started: 3/23
Drawn By:EH
Project #:

0000

SHEET
3